

SEE SHEET 2 OF 3
FOR SIDING IDEAS

PAINT ENTIRE INSIDE OF PLANTER
WITH THOMPSONS WATER SEAL. 2 COATS
W/ 24 HOURS BETWEEN COATS. THEN SPRAY
WITH OIL SOLUTION. USE 2 PARTS MINERAL SPIRITS
+ 1 PART LINSEED OIL.

LINE INSIDE W/ 1/6 MIL BLACK POLYETHYLENE
SHEETING PRIOR TO ADDING TOP SOIL.

NOTE: 2" x 8" CAP WILL CANTILEVER OUT
± 2 1/2" ON THE OUTSIDE + ± 1 1/2" ON THE INSIDE
OF THE 2" x 4" TOP PLATE + SIDING.
MITER CORNERS OF TOP CAP AT 45°.

SIDE VIEW OF FRAMING DETAIL

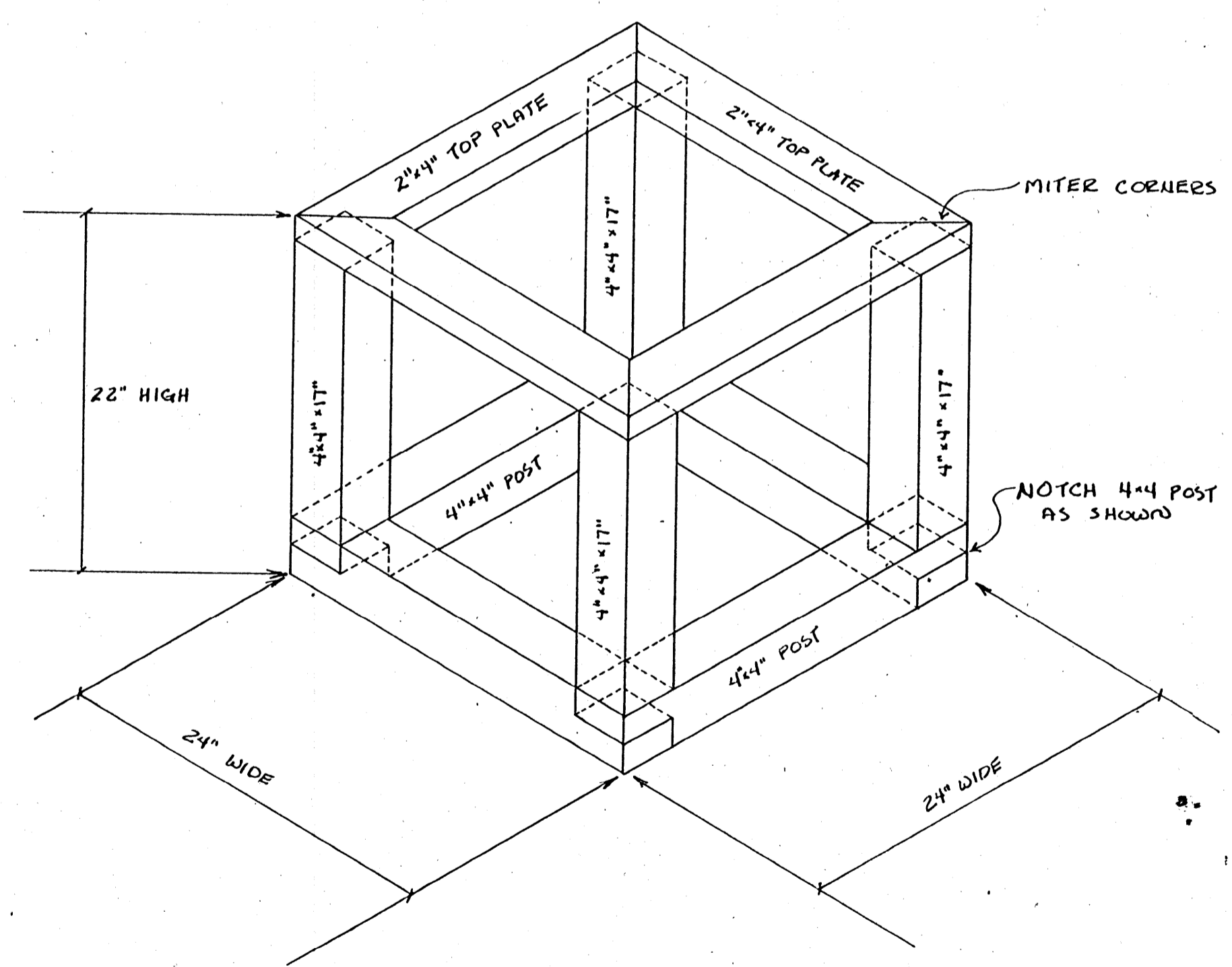

FRAMING DETAIL FOR PLANTER

MATERIALS LIST FOR FRAME

PIECES NEEDED	SIZES TO PURCHASE
(4) 4" x 4" x 2' POST	(2) 4" x 4" x 8' POST
(4) 4" x 4" x 17" POST	
(4) 2" x 4" x 2' BOARDS	(1) 2" x 4" x 8' BOARD
(4) 2" x 8" x 2' 5" TOP CAP	(1) 2" x 8" x 10' BOARD

SCALE : 1/2" = 1' 00"

FRAMING PLAN	PL. NO. 8507
<u>2' x 2' WOODEN PLANTER</u>	
DESIGN BY J. PERRY	SHEET
DRAWN BY D. FILES	1
DATE 3/1985	OF 3



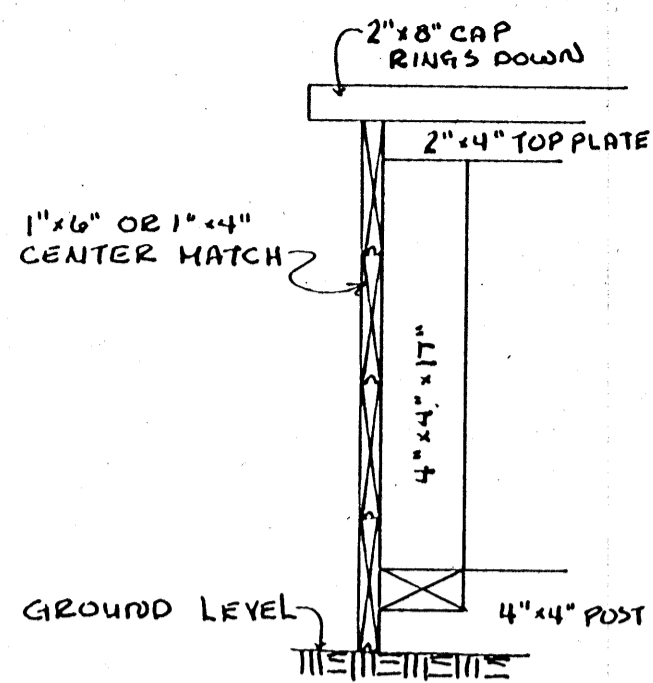

SECTION OF SIDING

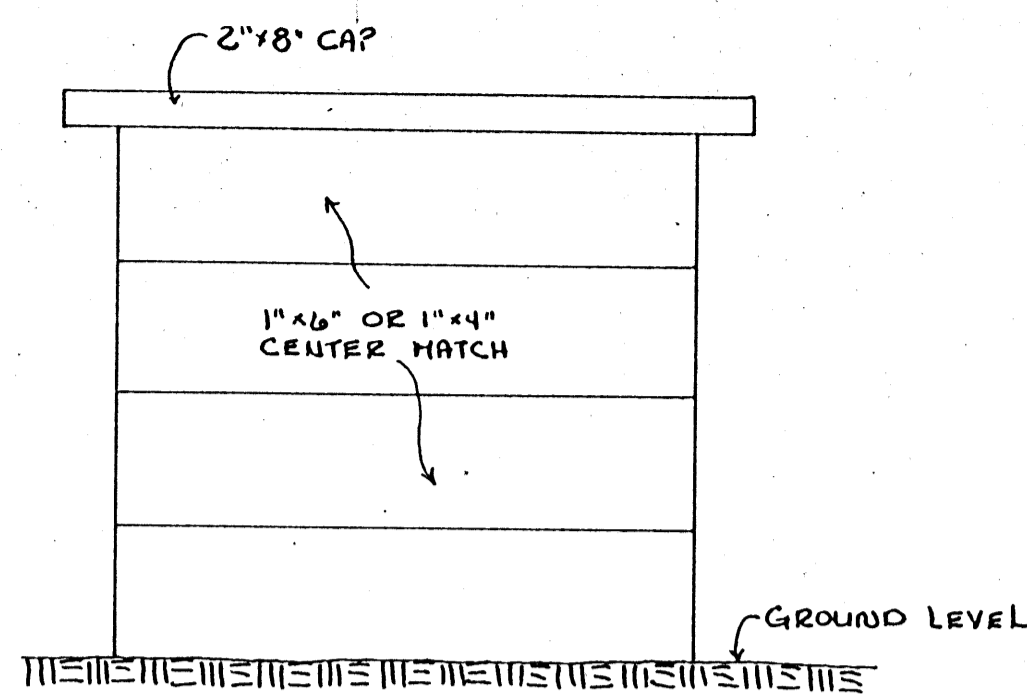

SIDE VIEW OF PLANTER
HORIZONTAL PATTERN

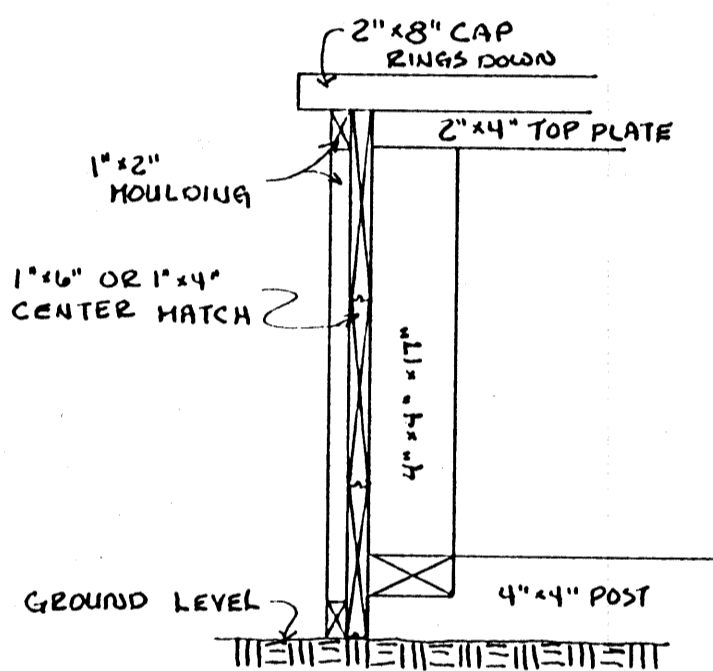

SECTION OF SIDING

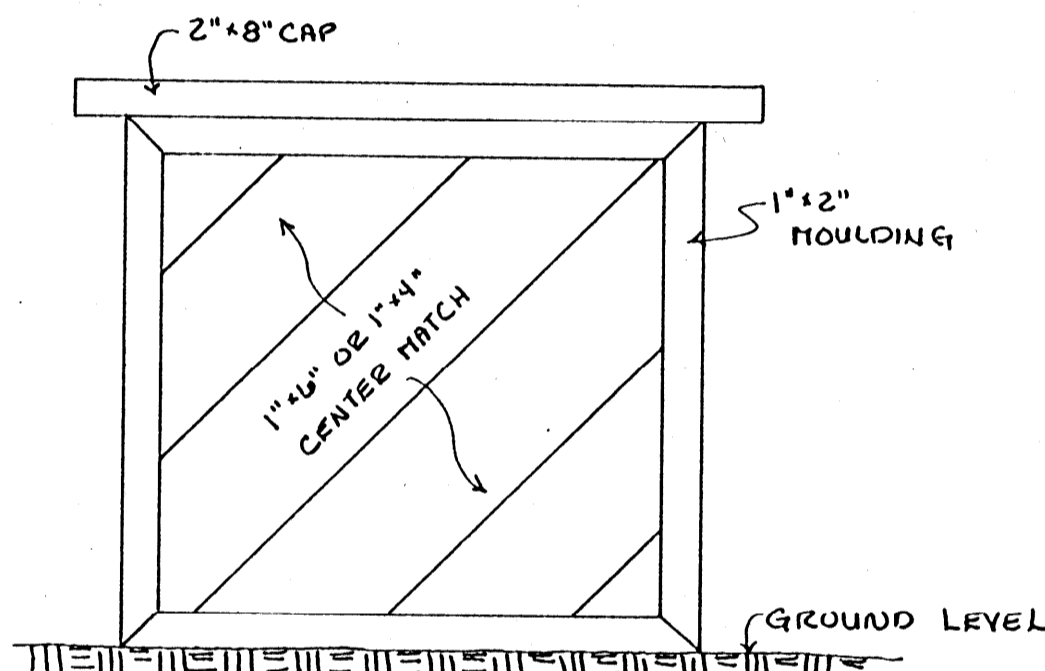

SIDE VIEW OF PLANTER
DIAGONAL PATTERN

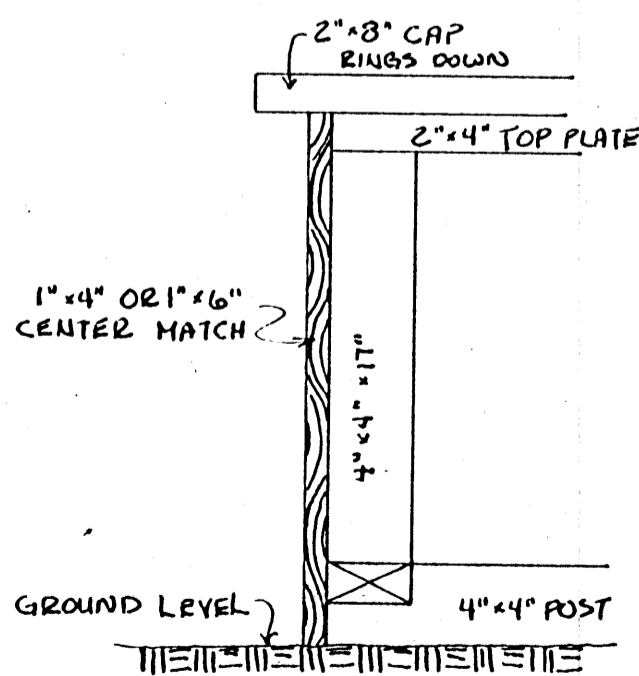

SECTION OF SIDING

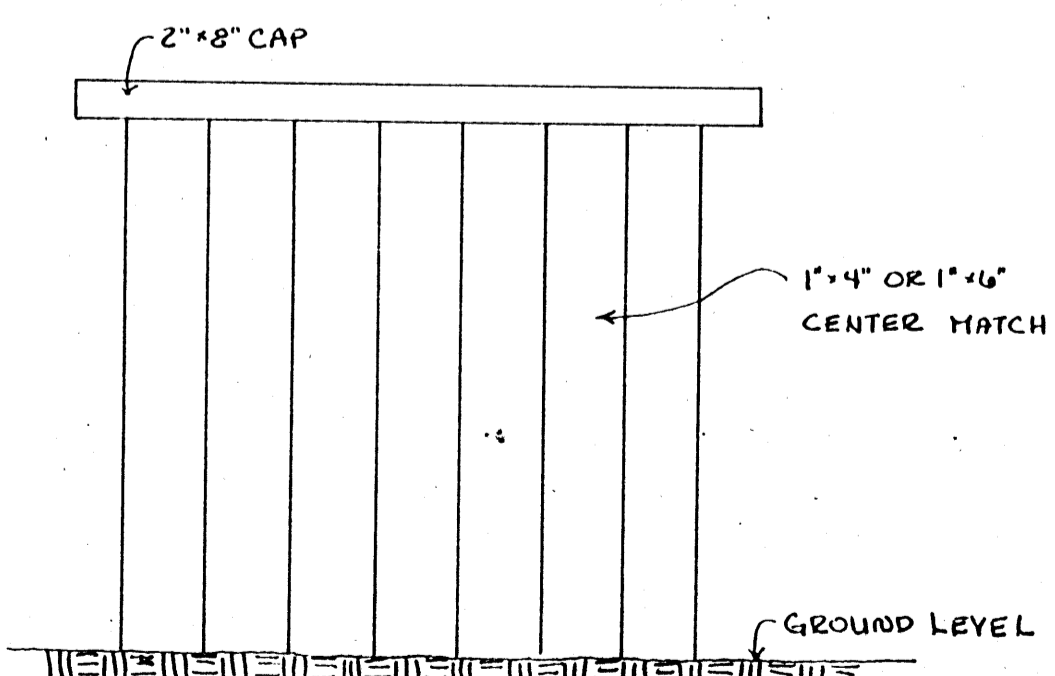

SIDE VIEW OF PLANTER
VERTICAL PATTERN

MATERIALS LIST FOR SIDING

- HORIZONTAL SIDING USING 1x6" MATERIAL:

<u>PIECES NEEDED</u>	<u>SIZES TO PURCHASE</u>
(16) 1x6"x2 1/2" CENTER MATCH	- (4) 1x6"x10' CENTERMATCH
- HORIZONTAL SIDING USING 1x4" MATERIAL:

(24) 1x4"x2 1/2" CENTER MATCH	- (7) 1x4"x10' CENTER MATCH	OR	(6) 1x4"x12' CENTER MATCH
-------------------------------	-----------------------------	----	---------------------------
- VERTICAL SIDING USING 1x6" MATERIAL:

<u>PIECES NEEDED</u>	<u>SIZES TO PURCHASE</u>
(18) 1x6"x22" CENTERMATCH	- (3) 1x6"x12' CENTER MATCH
- VERTICAL SIDING USING 1x4" MATERIAL:

(28) 1x4"x22" CENTER MATCH	- (5) 1x4"x12' CENTER MATCH	OR	(6) 1x4"x10' CENTER MATCH
----------------------------	-----------------------------	----	---------------------------
- DIAGONAL SIDING USING 1x6" MATERIALS:

<u>PIECES NEEDED</u>	<u>SIZES TO PURCHASE</u>
(24) 1x6" OF VARYING LENGTHS	- (4) 1x6"x10' CENTER MATCH
- DIAGONAL SIDING USING 1x4" MATERIAL:

(36) 1x4" OF VARYING LENGTHS	- (4) 1x4"x10' CENTER MATCH	OR	(1) 1x4"x12' CENTER MATCH
------------------------------	-----------------------------	----	---------------------------

NOTES FOR SOIL PREPERATION

1. ADD 3 INCHES COARSE GRAVEL
2. THEN ADD 2 INCHES OF MASONRY SAND
3. THEN ADD SOIL MIX PREPARED AS FOLLOWS:

MIX TOGETHER BEFORE ADDING TO PLANTER > 1 GALLON TOP SOIL
 4 GALLONS SAND
 2 GALLONS SHREDDED SPHAGNUM PEAT MOSS
 2 GALLONS ROTTED MANURE
 1 CUP BASIC SLAG

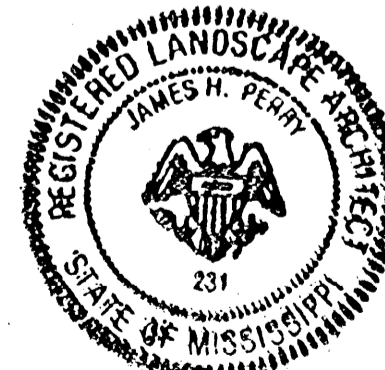

SCALE: 1/2" = 1'00"

SIDING PATTERNS		PL. NO. 8507
<u>2'x2' WOODEN PLANTER</u>		
MCS <small>Mississippi Cooperative Extension Service Mississippi State University USDA and County Cooperating</small>	DESIGN BY J. PERRY	SHEET
	DRAWN BY D. FILES	2
	DATE 3/1985	OF 3

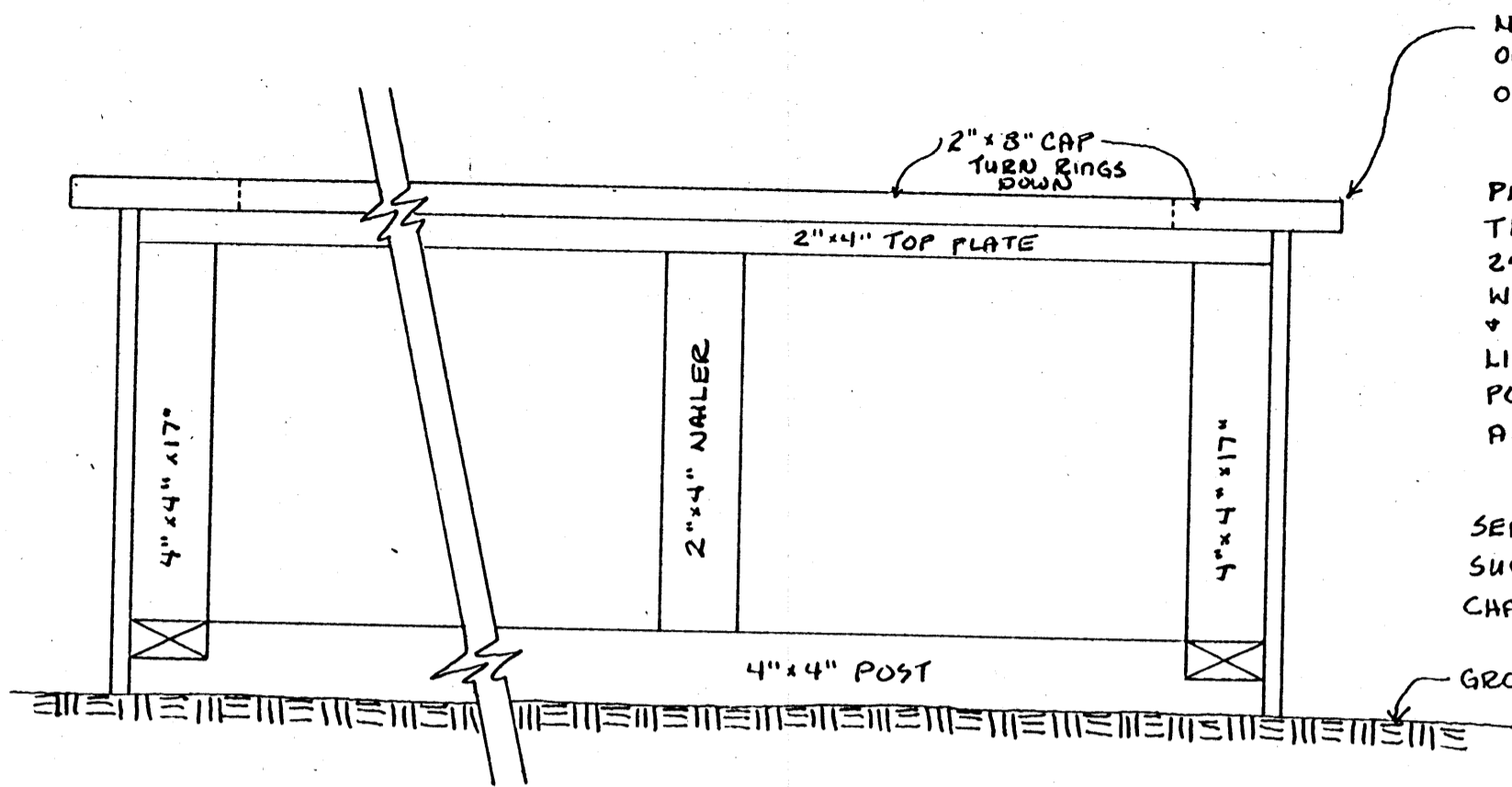

NOTE: 2"x8" CAP WILL CANTILEVER OUT 2 1/2" ON OUTSIDE + 1 1/2" ON INSIDE OF THE 2"x4" TOP PLATE + THE SIDING.

PAINT ENTIRE INSIDE OF PLANTER WITH THOMPSON'S WATER SEAL. USE 2 COATS 24 HOURS BETWEEN COATS. THEN SPRAY WITH OIL SOLUTION. USE 2 PART MINERAL SPIRITS + 1 PART LINSEED OIL.

LINE INSIDE WITH 6 MIL BLACK POLYETHYLENE SHEETING PRIOR TO ADDING TOP SOIL.

SEE SHEET 2 OF 3 FOR SIDING SUGGESTIONS. MATERIALS LIST WILL CHANGE DEPENDING ON PLANTER SIZE.

SIDE VIEW OF FRAMING DETAIL
(CONTINUE AS LONG OR ASWIDE AS NEEDED.)

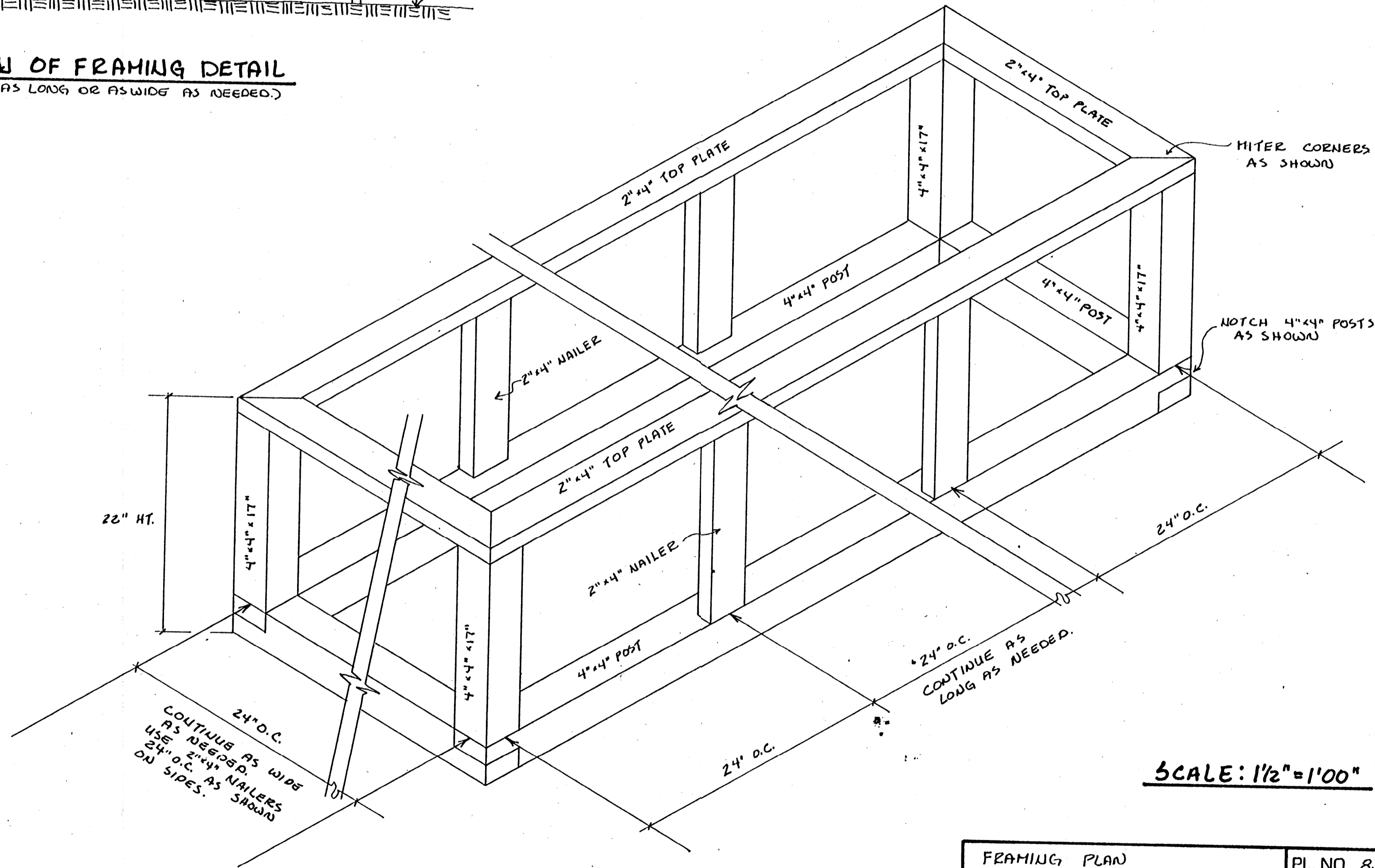

SCALE: 1/2" = 1'00"

FRAMING DETAIL FOR PLANTER



FRAMING PLAN	PL. NO. 8507
WOODEN PLANTER	
DESIGN BY J. PERRY	SHEET 3 OF 3
DRAWN BY D. FILES	
DATE 4/1985	